

installation Guide
User manual

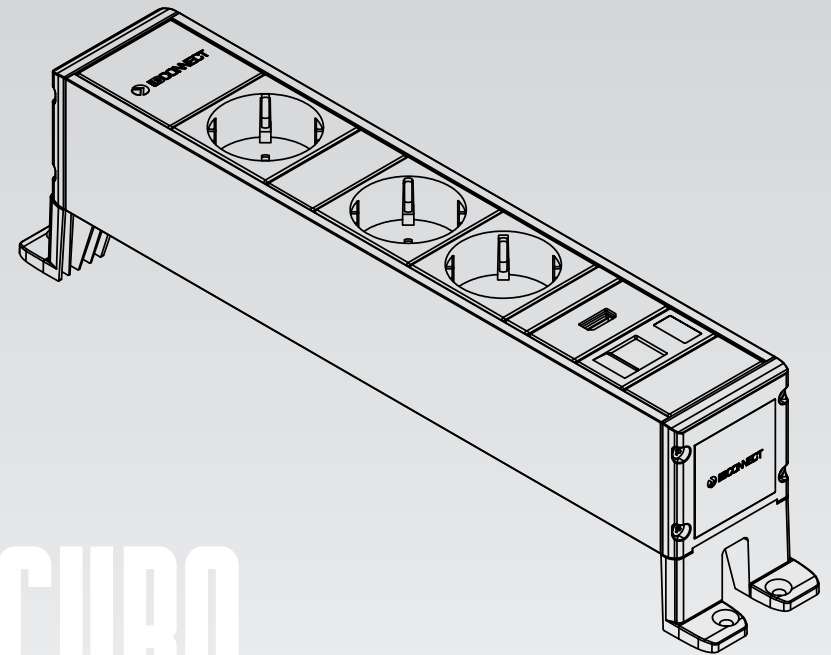

P El Escopar 5 31350 Peralta Navarra Spain T+34 948 753 282 F+34 948 751 462 comercial@ib-connect.com



CUBO

conexión en línea
connection in line

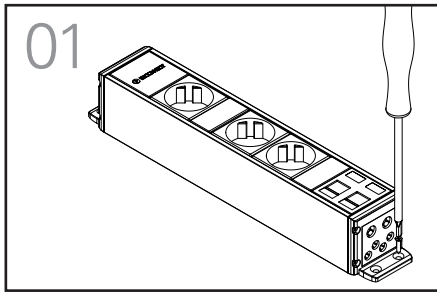

01 INSTALLATION CUBO FLAT ANCHOR
Use a Phillips head screwdriver to tighten the screws holding the side anchors.

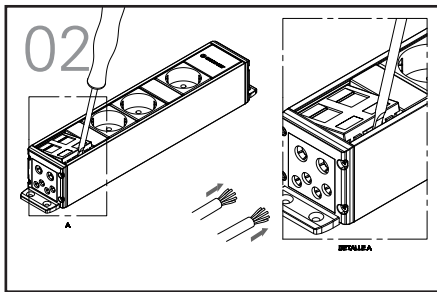

02 Remove the V/D connectors with a fine-tipped screwdriver.
Run the V/D cables through the opening in the end cover.

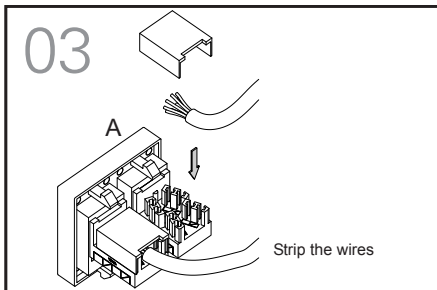

03 Attach the RJ-45 connectors on the cover connectors and crimp as shown in figure A.
Put the cover on the rail with the connectors and gather up the extra cable.

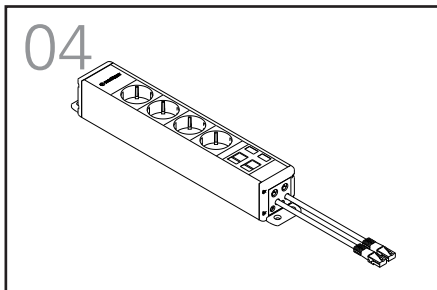

04 The profile frame is completely installed.

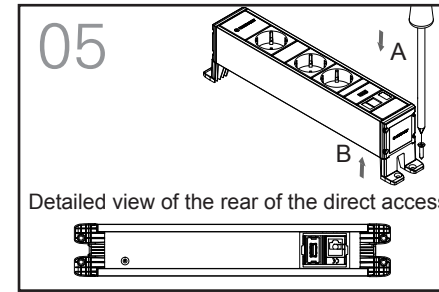

05 INSTALLATION CUBO RAISED ANCHOR
Use a Phillips head screwdriver to tighten the screws holding the side anchors.

This time, the entry to the connectors is direct with I/O connectors.

Connect power to the V/D: insert the cable into direct opening **B** and connect to the RJ-45, connect the other cable to the V/D plate **A**.

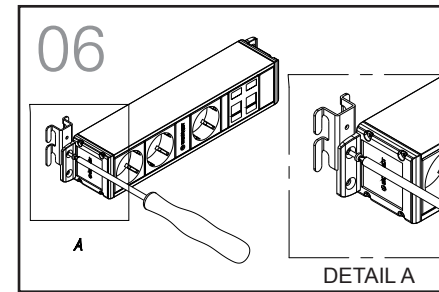

06 INSTALLATION CUBO CABLE GRATING
To install Cubo on a cable grating, screw part **A** to the side anchor as shown in detail **A**

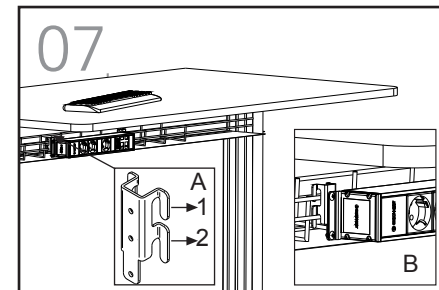

07 Once the anchor piece has been installed on the rail, insert tabs 1 and 2 shown in figure **A** into the grating, as shown in figure **B**. The rail will be securely anchored to the cable grating.

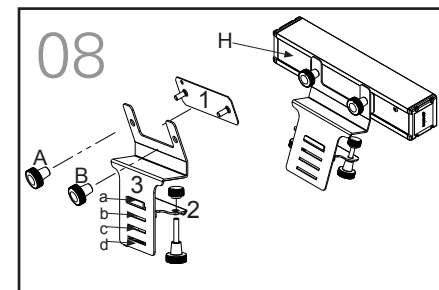

08 INSTALLATION ON SUPPORT
Insert piece 1 into the rear of the rail (H). Insert the pivots of piece 1 into the holes in piece 3 and secure with screws **A** and **B**. Put piece 2 into the slots in piece 3 (a, b, c, d) depending on the thickness of the desk, and secure to the desk with the screws in piece 2.

For any questions on the profile frame, contact us at:

oficinatecnica@ib-connect.com