

installation Guide
User manual

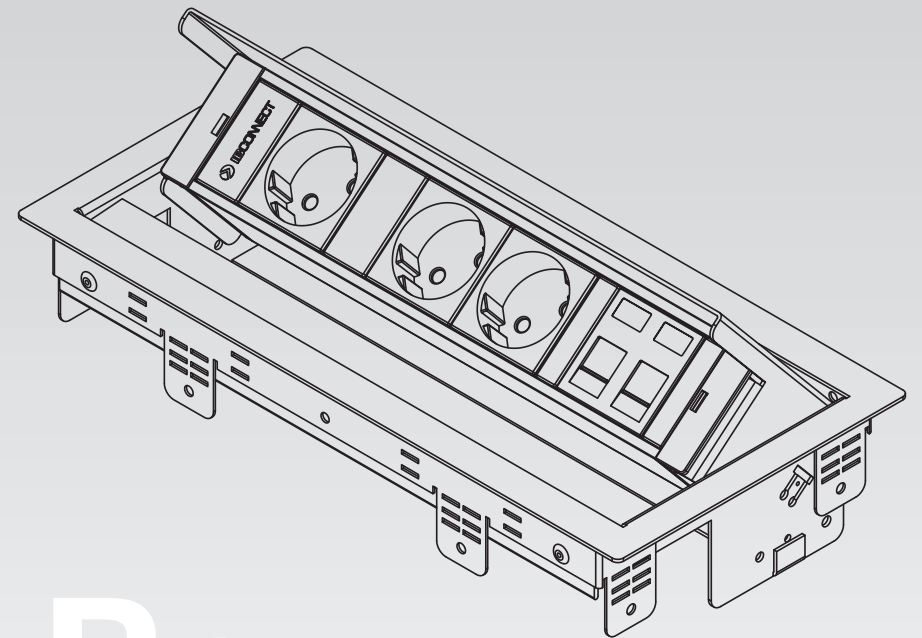

Box

abrir y conectar
open and connect

 **IBCONNECT**

P El Escopar 5 31350 Peralta Navarra Spain T+34 948 753 282 F+34 948 751 462 comercial@ib-connect.com

www.ib-connect.com

 **IBCONNECT**

01

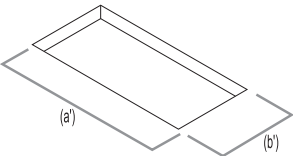

Modules	Box (mm)	Desk Cut (mm)
4M	(A) 319 x (B) 154 x (C) 63,5	(a) 294 (+1) x (b) 147 (+0,5)
6 M	(A) 409 x (B) 154 x (C) 63,5	(a) 384 (+1) x (b) 147 (+0,5)

IMPORTANT: Do not exceed the tolerance dimensions or the product will not be installed properly.

Cut an opening in the desk to recess the box with the measurements specified in figure 1.

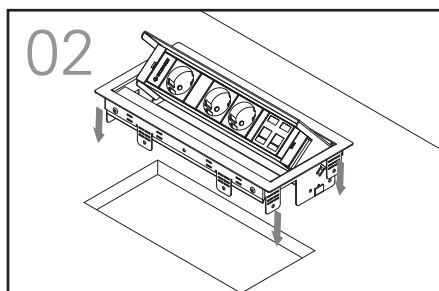

After you have cut the opening, insert the box through the top of the desk.

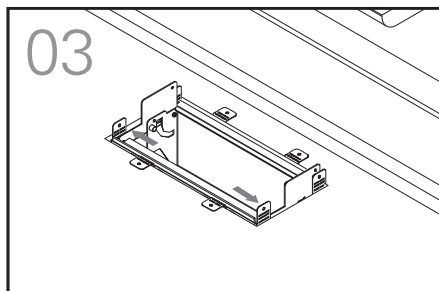

Bend the four tabs that are best suited for holding the box to the desk.

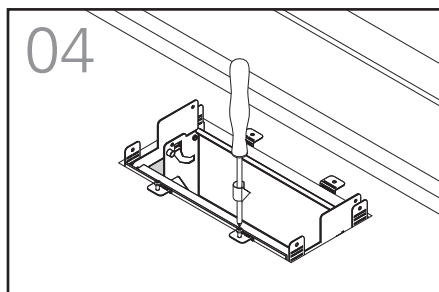

Use a Phillips head screwdriver to screw the tabs that you bent using the screws provided.

The box is completely installed.

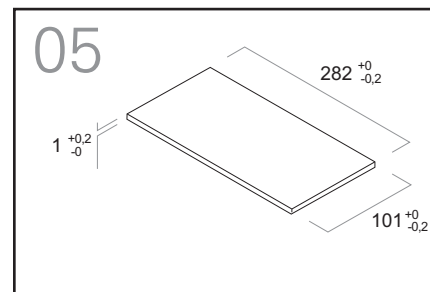

BOX PLUS COVER LAYER: To cover the Box Plus cover with a finish that matches the desk (wood or another material), cut a layer with the same dimensions shown in figure 5.

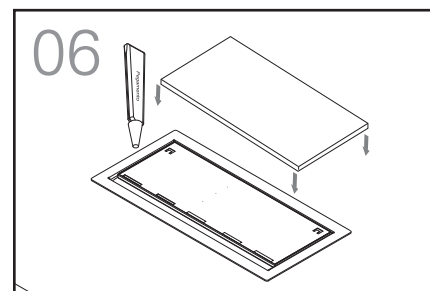

IMPORTANT: If necessary, respect the position and direction of the wood grain.

Contact adhesive is recommended for securing the material to the cover (in the case of wood or another porous material). For materials such as leather or synthetic leather, do not use adhesives containing cyanoacrylate.

Adhesive not supplied with the product.

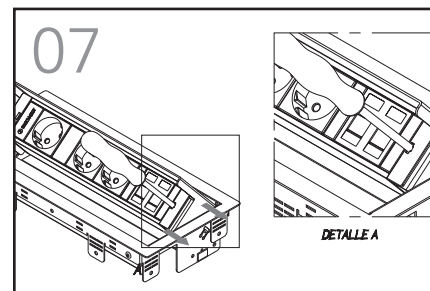

Insert a flat-head screwdriver into the holes in the rail tabs, levering, always towards the outside of the box.

IMPORTANT: Both tabs must be unlatched before the rail is pulled out.

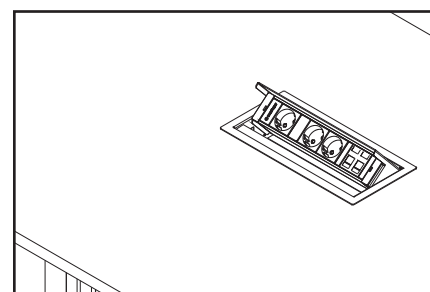

For any questions on the profile frame, contact us at:

oficinatecnica@ib-connect.com